

THE SMALLEST GROUP SIZES IN NISEKO

Don't get held up by the pack - more riding, more tips, more progress!

THE ONLY RENTAL & LESSON PACKAGES IN TOWN

Best value lessons when you book one of our packages

APPLIES TO SELECTED LESSONS ONLY. SEE PAGE 3 FOR DETAILS.

Welcome to NBS

NBS is Niseko's premier all-in-one Snowsports School, Rental & Retail provider. We pride ourselves on being able to offer the best quality lesson and rental service with an outstanding instructor to guest ratio and the **SMALLEST** group lesson sizes in Niseko! The experienced team at NBS look forward to sharing their knowledge and assisting you with everything you need for a great holiday in Niseko.

MAKING A BOOKING WITH NBS

Pre-bookings are highly recommended throughout the season and are essential for peak periods. You can conveniently book your NBS lessons and rental gear through your travel consultant who will be able to assist you with all of your enquiries.

SNOWSPORTS SCHOOL

Our international team of qualified Snowsports Instructors are incredibly passionate and keen to share their love of snowsports with you. They will have you experiencing all that this world class resort has to offer in no time at all. This experience is achieved by identifying your goals and taking every step possible to go above and beyond your expectations. If it's a new manoeuvre you are trying to master or technique you wish to improve, our highly skilled team can help.

LESSON TYPES

NBS offers the best value for money through our lesson and rental packages! With a wide range of group and private lessons on ski and snowboard to suit every ability from beginner to expert. We can also offer specialised private lessons such as:

- POWDER
- RACE
- MOGULS
- PARK
- FREESTYLE
- KIDS SPECIFIC
- ADAPTIVE
- TELEMARCK
- WOMENS SPECIFIC

NBS OPERATING HOURS

DATE	TIME	
DEC 1ST-DEC 15TH	8AM-6PM	7 DAYS A WEEK
DEC 16TH-MAR 17TH	8AM-8PM	7 DAYS A WEEK
MARCH 18TH-APRIL 12TH	8AM-6PM	7 DAYS A WEEK

Hours and Dates are subject to change & may vary slightly depending on time of season & lift operations.

LOCATION

NBS offers 3 central locations including the ski-in/ski-out **ALPEN RIDGE** complex at the base of ACE FAMILY chair lift. **UPTOWN**, a second rental/retail store located on the main street of Hirafu and an exclusive sales office on the ground floor of the **SNOW CRYSTAL** building.

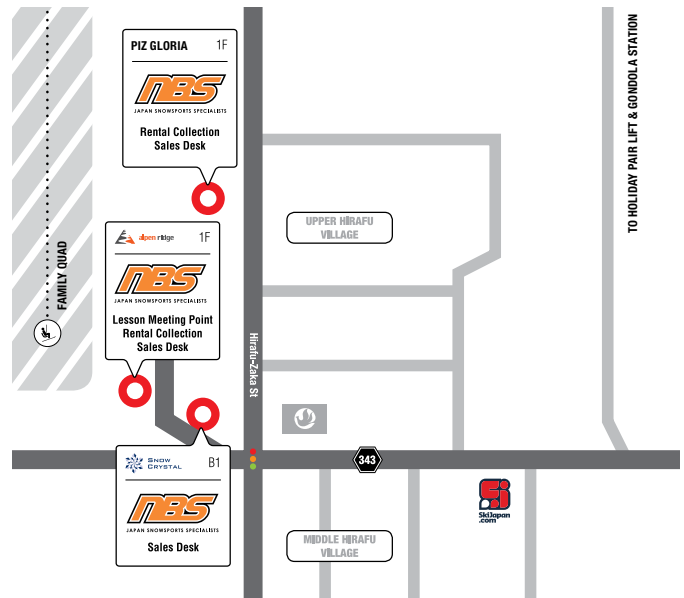

IMPORTANT INFO

- Please ensure that you carefully read our NBS ability chart and select the level that best describes you.
- Please bring your booking number/voucher with you to the lesson.
- Lift passes are not included in the lesson cost and must be purchased separately. This can be organized by your travel consultant or purchased in resort.
- Please ensure you have all equipment in working order prior to your lesson. Fitting rental gear is not part of the lesson time and can take up to 30 mins, please allow enough time for this before your lesson.
- All lessons meet in front of NBS/Alpen Ridge.
- All GROUP lessons operate in the Hirafu/Hanazono areas. 4, 6 & 7 hour privates, level 5 and above can ski all mountain.
- Please notify Kids Club Staff if your child has allergies. Please note that **ALLERGENS ARE PRESENT IN THE KIDS CLUB LUNCH ROOM** and we strongly advise that children with serious allergies are collected for lunch.

THE SMALLEST GROUP SIZES IN NISEKO

Don't get held up by the pack - more riding, more tips, more progress!

THE ONLY RENTAL & LESSON PACKAGES IN TOWN

Best value lessons when you book one of our packages

APPLIES TO SELECTED LESSONS ONLY. SEE PAGE 3 FOR DETAILS.

Skier Ability Chart

LEVEL	ABILITY
1	I have never skied before.
2	Have skied before at some point and can stop. Able to perform a confident snowplough and slight direction change.
3	Able to link snowplough turns on a beginner slope.
4	Almost parallel on green runs. Skis are still in a snowplough on steeper runs.
5	Completely parallel on all green runs, almost parallel on red runs.
6	Completely parallel on all red runs, almost parallel on black runs. Starting to ski easy off piste, small moguls. May be experimenting in beginner terrain park.
7 PRIVATE ONLY FOR ADULTS	Confidently skiing parallel on groomed black runs. Starting to do short turns and experiment in the bumps, trees and powder. May be able to ski through intermediate terrain park.
8 PRIVATE ONLY FOR ADULTS	Skis all terrain confidently. Carving all groomed runs, Carving short turns. Confidently skiing mogul lines, trees and powder. May be comfortable in all terrain parks.

Snowboarder Ability Chart

LEVEL	ABILITY
1	I have never snowboarded before.
2	Able to perform toe-side and heel-side falling leaf.
3	Able to make a basic toe-side and heel-side turn but not yet linking the two.
4	Confidently linking turns down most Green runs.
5	Able to ride red runs, starting to ride switch on greens, experimenting in the beginner terrain park.
6	Confidently riding on all red runs. Able to ride black groomed runs. Starting to ride the halfpipe, boxes, off piste, powder and confidently riding switch on greens.
7 PRIVATE ONLY	Confidently carving all groomed runs. Riding powder, trees and steep off-piste with ease. Able to ride intermediate terrain park and perform grabs, board slides and 180 spins. Riding switch on reds.
8 PRIVATE ONLY	Rides all terrain confidently both regularly and switch. Able to perform advanced freestyle manoeuvres in the advanced terrain park.

It is **CRITICAL** that you book into the correct ability level. To assist in accurately determining your level please watch the video [here](#).

Lesson Prices

PRIVATE LESSONS		UP TO 20% OFF PRIVATE LESSONS FROM THE 1ST MARCH* * Does not include Super Saver packages.	
1 Hour Private	¥14,000	8:30 & 16:00	
2 Hour Private	¥22,000	8:30, 10:30, 13:30, 16:00, 18:00	
3 Hour Private	¥32,000	9:30 (n/a peak periods), 13:30, 16:00	
4 Hour Private	¥40,000	8:30, 10:30, 13:30	
6 Hour Private	¥56,000	8:30, 10:30 or 13:30 start only. 6hrs tuition + 1hr break	
All Day FLEXI Private	¥60,000	Start anytime (8:30-12:30) 7hrs tuition + 1hr break	
Super Saver Package 5 x 2 hour private	¥88,000	8:30 & 13:30 same time, consecutive days only	
Super Saver Package 5 x 3 hour private	¥128,000	13:30 only on consecutive days	
Off Peak Super Saver Package 5 x 2 hour private	¥70,000	4pm or 6pm same time on consecutive days	
Additional Person Fee	¥3,000	Private prices include 2 people, additional person fee applies up to a max of 5	

LESSON & RENTAL PACKAGES
Pre-booking only, not available in-resort.

TODDLER TESTER ¥15,000 1 Day Standard Rental + 1hr Private at 8:30	5 DAY LESSON & RENTAL PACKAGE (5yrs+) ¥55,000 5 Days Rental + 5 All Day Group Lessons
---	---

THE ONLY RENTAL & LESSON PACKAGES IN TOWN
Best value lessons when you book one of our packages

MAX 5 ADULT GROUP LESSONS				
SKI OR SNOWBOARD MAX 5 PEOPLE LEVELS 1-6	Morning		¥9,000	10:30-12:30
	All Day (Snowboard not available peak season)		¥12,000	10:30-15:30 Snowboard N/A peak season.
	Super Saver 20% SAVING!	5 x morning	¥36,000	Consecutive days only
		5 x all day	¥48,000	

KIDS GROUP LESSONS				
POWDER PUPPIES FOR AGES 3-4 MAX 2 KIDS LEVEL 1-4 SKIERS	Morning		¥15,000	10:30-12:30
	All Day		¥18,000	10:30-15:30 Lunch included
	Super Saver 20% SAVING!	5 x morning	¥60,000	Consecutive days only
		5 x all day	¥72,000	
LITTLE RIPPERS FOR AGES 5-8 MAX 6 KIDS LEVEL 1-8 SKIERS	Morning		¥10,000	9:30-12:30
	All Day		¥13,000	9:30-15:30 Lunch included
	Super Saver 20% SAVING!	5 x morning	¥40,000	Consecutive days only
		5 x all day	¥52,000	
FREESTYLAZ FOR AGES 9-14 MAX 6 KIDS LEVEL 1-8 SKIERS	Morning		¥10,000	9:30-12:30
	All Day		¥13,000	9:30-15:30 Lunch included
	Super Saver 20% SAVING!	5 x morning	¥40,000	Consecutive days only
		5 x all day	¥52,000	
RIDE TRIBE FOR AGES 7-14 MAX 6 KIDS LEVEL 1-6 SNOWBOARD	Morning		¥9,000	10:30-12:30
	All Day		¥12,000	10:30-15:30 Lunch included
	Super Saver 20% SAVING!	5 x morning	¥36,000	Consecutive days only
		5 x all day	¥48,000	
EARLY KIDS DROP-OFF	1 Hour		¥1,500	Available at 8:30 and 09:30

SPECIALIST CAMPS			
JUNIOR MOUNTAIN RIDERS 7-17 YEARS SKI/SNOWBOARD/TELE - ALL LEVELS	1 Day	¥52,000	Price includes 4 kids. Additional participants ¥5,000 to max 7. Flexi-start 6hrs per day. Lunch included. Mixed groups ok.

PEAK PERIOD DATES:
Christmas Peak: 14th Dec, 2019 – 6th Jan, 2020
Chinese New Year Peak: 20th Jan, 2020 – 30th Jan, 2020

LESSON OPERATION DATES:
All Ski Groups: 10th Dec, 2019 – 4th April, 2020
All Snowboard Groups: 10th Dec, 2019 – 15th Mar. 2020
Private Lessons: 1st Dec, 2019 – 19th April, 2020

KIDS LESSON NOTES: We strongly suggest that children with allergies are collected for lunch as they may be exposed to allergens in the kid lunch room.

EARLY KIDS DROP-OFF NOTES: This is only available to children booked in 9:30 Kids Ski or 10:30 Kids Snowboard lessons. Price is per hour for a maximum of 2 hours. 6 or 7 hour private lessons starting at 8:30 include free "early drop-off". Kids must be booked in Kids groups. Max 2 children per private.

PRIVATE LESSON NOTES: All private lesson prices indicate the cost for up to 2 students per lesson. Additional students may join at a cost of ¥3,000 per student per lesson. There is a maximum of 5 students in any private lesson. *It is ESSENTIAL that all guests in a private lesson are of similar skiing or snowboarding ability. Combining private lesson participants by age is also beneficial.

GENERAL LESSON NOTES: Super Saver Package must be taken on consecutive days. No guest, date or time changes are allowed. Must be same discipline i.e. ski OR board for the duration. *We strongly recommend that customers pre-book lessons, particularly during the peak season. *Spring Lesson specials are effective from 1st March - end of season.

* Conditions apply for all specials - please speak to your travel consultant for details or refer to T&C page 5.

TRAINING ASPIRING JUNIOR SKIERS AND BOARDERS AGED 7-18 YEARS FOR COMPETITION SUCCESS

Mobile program operating in Niseko, Moiwa, Rusutsu & Kiroro.
Select group of qualified and experienced coaches focusing on GS, Skiercross and Moguls.

SjTA

www.SjTA.net

THE SMALLEST GROUP SIZES IN NISEKO

Don't get held up by the pack - more riding, more tips, more progress!

THE ONLY RENTAL & LESSON PACKAGES IN TOWN

Best value lessons when you book one of our packages

APPLIES TO SELECTED LESSONS ONLY. SEE PAGE 3 FOR DETAILS.

NBS Rental

NBS Rental has all of the equipment you need to enjoy your time on the mountain. Our high quality rental fleet includes new skis/boards from top brands such as K2, Head, Ride, Line, Armada and Burton giving you the option of every type of ski or board for all conditions. Whether you are a beginner or advanced, our expert rental technicians can put you on the skis/board most suited to your ability and preferred style of riding. We also carry a selection of the latest rocker technology and camber style skis and boards.

DAY		1	2	3	4	5	6	7	EXTRA
SKIS OR BOARD ONLY	DELUXE ADULT	5,000	10,000	14,500	18,500	21,000	24,500	27,500	2,000
	STANDARD ADULT	4,000	8,000	11,000	13,000	16,000	18,500	20,000	1,000
	DELUXE CHILD	3,500	7,000	9,500	11,000	13,500	15,500	16,500	500
	STANDARD CHILD	3,000	6,000	8,000	9,500	12,500	13,500	14,500	500
SKI/BOARD PACKAGE WITH BOOTS, POLES & BINDINGS	DELUXE ADULT	6,000	12,000	16,000	20,000	24,000	27,000	31,500	2,000
	STANDARD ADULT	4,500	9,000	12,000	15,500	17,500	19,500	21,500	1,000
	DELUXE CHILD	4,000	8,000	10,500	13,000	15,500	18,000	22,000	500
	STANDARD CHILD	3,500	7,000	9,000	10,500	13,500	15,000	16,500	500
CHILD PACKAGE WITH HELMET	DELUXE CHILD	5,000	9,500	12,500	15,500	18,500	21,000	23,500	500
	STANDARD CHILD	4,500	8,500	11,000	13,000	16,500	18,000	19,250	250
BOOTS ONLY	ADULT	2,500	3,500	4,500	5,000	5,500	6,000	6,500	1,000
	CHILD	1,500	2,500	3,000	3,500	4,000	4,500	5,000	500
HELMET	ALL SIZES	1,500	2,000	2,500	3,000	3,250	3,500	3,750	250
JACKET & PANTS	ADULT	3,000	4,500	5,500	6,500	7,500	8,000	8,500	500
	CHILD	2,000	3,000	3,500	4,000	4,500	5,000	5,500	250
JACKET OR PANTS	ADULT	2,000	3,000	3,500	4,000	4,500	4,800	5,100	300
	CHILD	1,000	1,500	1,800	2,000	2,250	2,500	2,750	250

THE SMALLEST GROUP SIZES IN NISEKO

Don't get held up by the pack - more riding, more tips, more progress!

THE ONLY RENTAL & LESSON PACKAGES IN TOWN

Best value lessons when you book one of our packages

APPLIES TO SELECTED LESSONS ONLY. SEE PAGE 9 FOR DETAILS.

Terms & Conditions

GENERAL T&C

1. NBS refers to NBS Japan – a rental, retail and snow sports school owned and operated by SkiJapan.com
2. No employee, servant or agent of NBS has the authority to vary these conditions.
3. All NBS services are non-transferable and non-refundable.
4. You must have or you agree that you do have valid travel insurance which covers you for accidents or injuries sustained during snowsports activities.
5. Payment of any monies constitutes acceptance of NBS terms and conditions.
6. It is the responsibility of the person paying to inform all other people in the booking group of all terms, conditions and general info.
7. The person who pays shall be primarily liable for all fees for the entire group in the event of any cancellation.
8. All NBS products and services are subject to availability.
9. All NBS multi-day services are based on consecutive days.
10. In the event of any discrepancy in terms and conditions between print and web content the website supersedes all print content.

LESSON T&C

11. In taking a lesson with NBS the customer, parent or guardian understands that snowsports can be dangerous and may result in injuries. NBS will not be held liable for any injuries or accidents occurring before, during or after any service has taken place. NBS is not liable for any equipment that is lost or damaged during a lesson, this includes any replacement costs or lost lesson time.
12. All lessons have a meeting time 10 minutes prior to lesson start time. Group lesson bookings are deemed to be cancelled if the student does not show up within 20 minutes after the lesson start time.
13. All Super Saver Packages must be taken on consecutive days. No guest, date or time changes are allowed. Must be same discipline i.e. ski OR board for the duration.
14. Cancellations by guest as a result of bad weather will not be refunded. Only official Resort staff can declare the mountain closed.
15. NBS reserves the right to merge groups of differing age and ability level.
16. Minimum age for group ski lessons is 3 years, must be toilet trained. Proof of age may be requested for kids participating in lessons. Minimum age for children's group snowboard lessons is 7 years old. Children under these ages can book a private ski/ snowboard lesson only.
17. Private lesson prices include up to 2 people per lesson. Additional people can join for ¥3,000 per person per lesson to a maximum of 5 people.

18. Lift tickets must be purchased prior to the start of the lesson. Parents or guardians are responsible for ensuring their children have a valid lift ticket. Any part of any lesson missed as a result of not having a valid lift ticket is non-refundable or transferable.
19. Parents or guardians of any child booked into group lessons MUST have fully completed a registration form prior to the lesson start time. Failure to do so could result in parents or guardians not being advised in the event of an emergency.
20. In taking a full day lesson that includes lunch, you agree that you/your child may be exposed to potential allergens for which NBS will not be held liable.

RENTAL T&C

21. Extensions can be made prior to the equipment being returned to receive the continuous daily rate. Any subsequent rentals will be charged as a new rental period.
22. Rental exchange between different equipment types and sizes of the same value for no additional cost is available FREE for all products in our deluxe package. For people renting standard equipment the following applies:
 - a. A maximum of 2 exchanges of the same type of equipment (i.e. ski to ski).
 - b. One exchange between different types of equipment (i.e. ski to snowboard).
23. Pre-booked rental equipment can be picked up after 4pm of the preceding day, if you want to pick up earlier you will be charged an additional days rental.
24. Children's pricing is valid for children aged up to and including 14 years old at time of rental.

LOSS & DAMAGED RENTAL EQUIPMENT POLICY

Whilst normal wear and tear is expected, excessive damage will be charged subject to the repair cost at a maximum fee of 12 days rental of that individual item. Lost equipment will be charged at a replacement value of 12 days rental of that individual item, or the subsequent rental days until it is returned to the store – whichever is the lesser amount.

BOOKING & CANCELLATION POLICY

For complete booking conditions and cancellation policy please contact your travel consultant. For full terms and conditions see in store or refer to your travel consultant.

EARLY BIRD NBS SPECIAL

15% Off Selected NBS Lessons

- Book and Pay by 1st August 2019.
- Not available 14th Dec 2019 – 6th Jan 2020 & 20th Jan 2020 – 30th Jan 2020.
- 15% off group lessons
- 15% discount on 2 hour private lesson applies to the 13:30 timeslot only

- Does not apply to Super Saver packages.
- Not valid with lesson/rental packages.
- Not valid with other NBS offers

Free Kids Rental OR 15% Off Rental

- Book and Pay by 1st August, 2019.
- Not available 14th Dec 2019 – 6th Jan 2020 & 20th Jan 2020 – 30th Jan 2020.
- Kids Ski Free Package is only available when booked with SkiJapan.com accommodation package.
- 1x full price adult ski / board package gets 1x child ski / board package + helmet
- Kids Ski Free package is determined by the adult rental package booked.
- Minimum of 5 days rental for Free Kids Rental.
- Child age 3-14 years (proof of age required).
- Not valid with lesson/rental packages.
- Not valid with any other NBS specials or promotions.

NBS SPRING SPECIALS

NBS Private Lessons

- Discount applies from 1st March, 2020
- 1 hour: ¥12,000 (down from ¥14,000)
- 2 hours: ¥18,000 (down from ¥22,000)
- 3 hours: ¥26,000 (down from ¥32,000)
- 4 hours: ¥32,000 (down from ¥40,000)
- 6 hours: ¥45,000 (down from ¥56,000)
- 7 hours: ¥52,000 (down from ¥60,000)

20% Off Rental

- Discount applies from 1st March, 2020.
- Minimum of 5 days rental.
- Not valid with any other NBS specials or promotions

Free Kids Rental

- Available from 1st March, 2020.
- 1 x full price adult ski / board package gets 1x child ski / board package + helmet
- Kids Ski Free package is determined by the adult rental package booked.
- Minimum of 5 days rental for Free Kids Rental.
- Clothing not included and available at regular rates.
- Child age 3-14 years (proof of age required).
- Not valid in conjunction with any other rental specials or promotions